

**AN EXEMPLARY LAYOUT PLAN FOR A BLOOD BANK (REVISED)**  
**(SCH. F - PART XII B - TO BE FOLLOWED)**

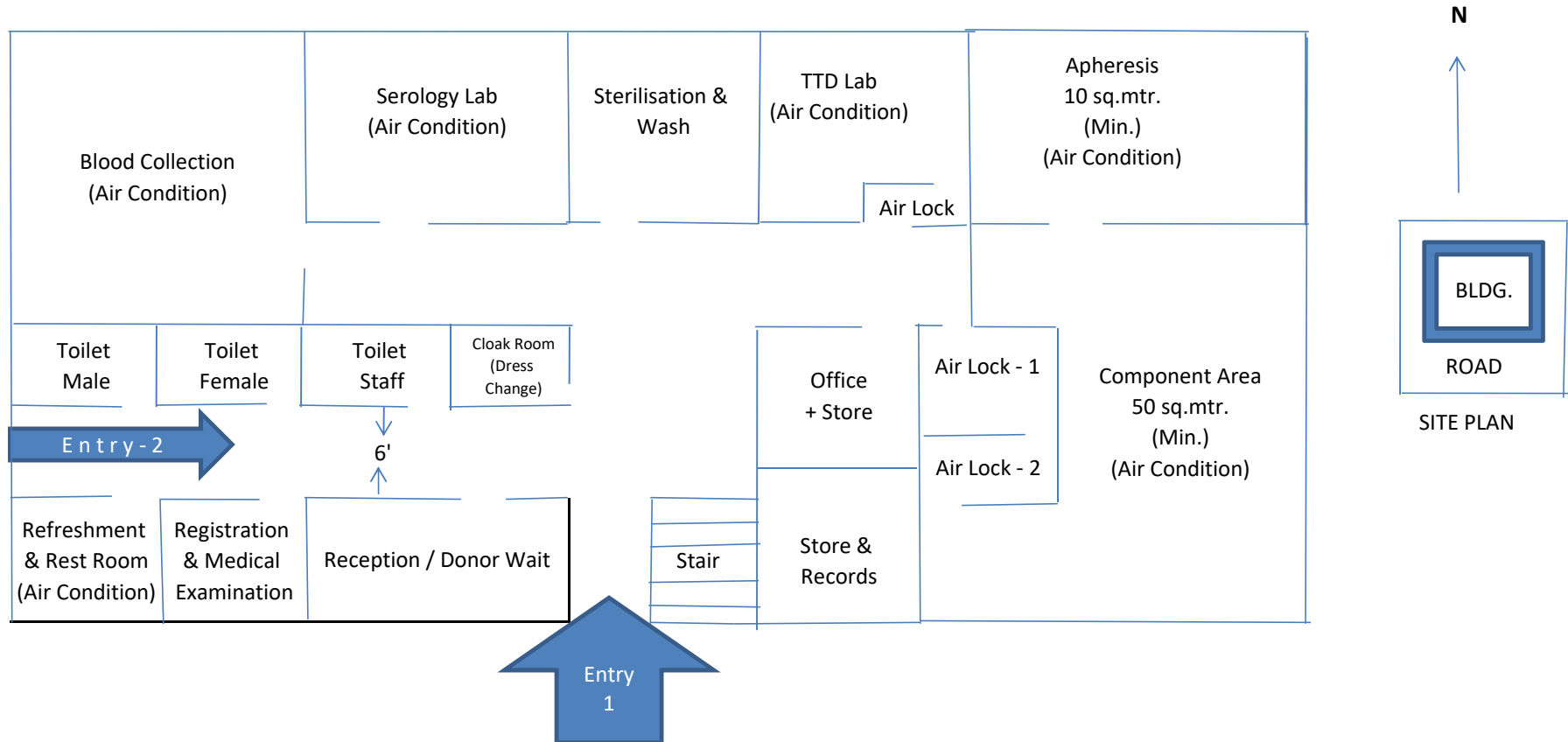

**Minimum Area Required :**    100 sq.mtr. Blood Banking (Whole Blood) + 50 sq.mtr. Components + 10 sq.mtr. (Apheresis)